

HL LED Series Industrial Handlamps

Jobsite Lighting

Standard Features:

- High impact, shatter-proof tube with replaceable frosted tube shield
- Beam angle available in 200° and 360°
- Wired with 15A, 125V, watertight plug
- Driver range of 100-277 volts at 50/60 Hz
- Environmental rating: Suitable for outdoor use in wet locations

Optional Features:

- Replaceable clear tube shield protector
- Handle switch available on **HL06** and **HL11** models- **Add HS**
- Other NEMA plug, configurations available
- Custom cable color and printing available
- Can be included with cable reel applications
- Contact Ericson for custom configurations

Market Applications:

- Maintenance Task Lighting
- Confined Space Entry
- Aerospace
- Food & Beverage
- Ship Building
- Petrochemical
- Power Generation
- Mining
- Emergency Response
- Military Applications



Unique Features:



High abuse rubber cap with steel hook.

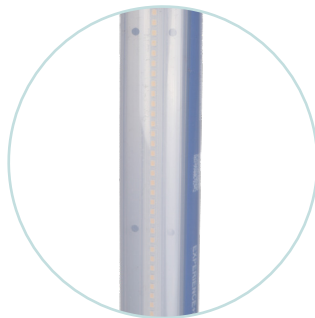

Clear, high impact, shatter proof lens with frosted shield.



Watertight NEMA 5-15 Ericson Perma-Tite Plug



Handle with switch available on **HL06** and **HL11**. Add-**HS**.



Selection Guide:

Part Number	Lamp Size	Total Net Lumens	16/3 SOOW Yellow Cord Length	Handlamp LED Type	Beam Angle	Electric Rating	Color
HL06-16306Y-1-D*	6"	1000	6	Directional	200	120V, 0.05A, 50/60HZ	4000K
HL06-16325Y-1-D*	6"	1000	25	Directional	200	120V, 0.05A, 50/60HZ	4000K
HL06-16350Y-1-D*	6"	1000	50	Directional	200	120V, 0.05A, 50/60HZ	4000K
*For Handle and Switch, add -HS to end of part number. Available in HL06 and HL11 models.							
HL11-16306Y-1-D*	11"	1800	6	Directional	200	120V, 0.10A, 50/60HZ	4000K
HL11-16306Y-1-360*	11"	1800	6	Omni-directional	360	120V, 0.10A, 50/60HZ	4000K
HL11-16325Y-1-D*	11"	1800	25	Directional	200	120V, 0.10A, 50/60HZ	4000K
HL11-16325Y-1-360*	11"	1800	25	Omni-directional	360	120V, 0.10A, 50/60HZ	4000K
HL11-16350Y-1-D*	11"	1800	50	Directional	200	120V, 0.10A, 50/60HZ	4000K
HL11-16350Y-1-360*	11"	1800	50	Omni-directional	360	120V, 0.10A, 50/60HZ	4000K
HL22-16306Y-1-D	22"	3800	6	Directional	200	120V, 0.21A, 50/60HZ	4000K
HL22-16306Y-1-360	22"	3800	6	Omni-directional	360	120V, 0.21A, 50/60HZ	4000K
HL22-16325Y-1-D	22"	3800	25	Directional	200	120V, 0.21A, 50/60HZ	4000K
HL22-16325Y-1-360	22"	3800	25	Omni-directional	360	120V, 0.21A, 50/60HZ	4000K
HL22-16350Y-1-D	22"	3800	50	Directional	200	120V, 0.21A, 50/60HZ	4000K
HL22-16350Y-1-360	22"	3800	50	Omni-directional	360	120V, 0.21A, 50/60HZ	4000K

Stringlight Accessories & Replacement Parts:

Part Number	Description	Image Reference
910-CH	Replacement end Cap with Metallic Hook	A
TS-14	Lens shield 1' (4pcs per package)	B
TS-24	Lens shield 2' (4pcs per package)	B
TS-14-F	Frosted lens shield 1' (4pcs per package)	B
TS-24-F	Frosted lens shield 2' (4pcs per package)	B
1510-PW6P	NEMA 5-15 watertight plug	C
MOUNT-MAG-CLAMP	Magnet Mount, 2-Pack with Tube Clamp	E
MOUNT-MAG-HOOK	Magnet Mount, 2-Pack with Hookeye	F
MOUNT-MAG-STRAP	Magnet Mount, 2-Pack with 8" Velcro Strap	G
MOUNT-STRAP-18	Velcro Strap 2-Pack 18x3/4" Black 2-Pack	H

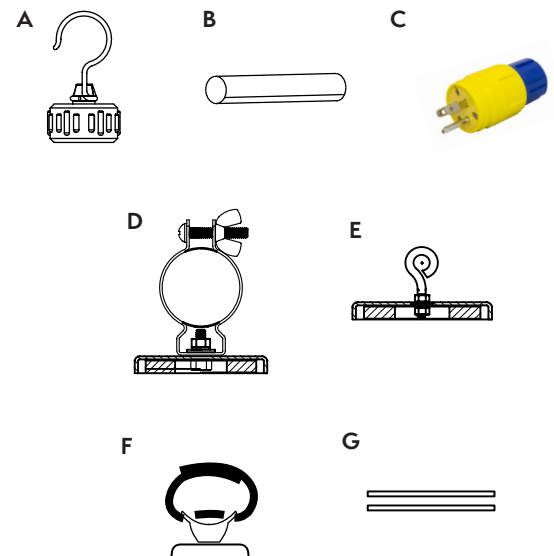

** For HL06 Use Series TS-14 or TS-14F.

Complimentary Temporary Power and Lighting Layout

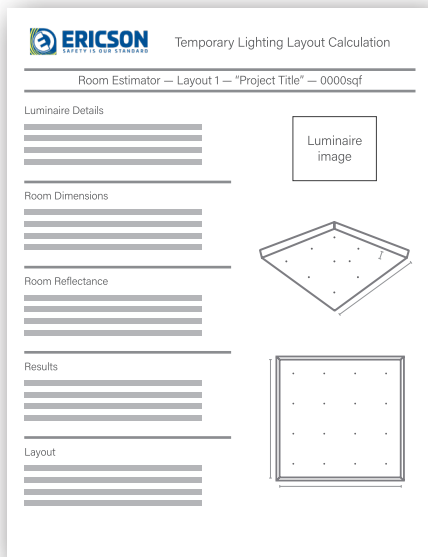

Representation only.

Determine How Much Temporary Light and Portable Power You Need for Your Job Site with Our Layout Service

The Federal agency for Occupational Safety and Health Administration (OSHA) has regulation standards for minimum illumination intensities required for certain areas of operation. Hence the importance in understanding foot candles & lumens.

The advantages of today's technology help evaluate dimensional spaces with the need for lumen efficacy or foot-candle footage. Having the proper illuminance and safe power distribution for your project can save you time and money on your next job site.

Let the experts at Ericson help you understand exactly what is needed on your next job.

Visit: ericson.com/layout

Related Products:



7 & 9
Industrial Grade Handlamp



70N
Handlamp



2600
Handlamp Series



Ericson Manufacturing Company
4323 Hamann Parkway
Willoughby, OH 44094, USA



1-800-374-2766
info@ericson.com
L1000850B

ericson.com